



Main

| | |
|---------------------------------------|--------------------|
| Accessory / separate part designation | 90° fixing bracket |
| Product or component type | 90° fixing bracket |
| Accessory / separate part destination | Ø 12 mm sensor |
| Accessory / separate part category | Fixing accessories |
| Accessory / separate part type | Bracket |

Complementary

| | |
|-----------------------|-----------------|
| Product compatibility | XX5 diameter 12 |
| Material | Metal |

Packing Units

| | |
|------------------|----------|
| Package 1 Weight | 0.030 kg |
| Package 1 Height | 0.320 dm |
| Package 1 width | 0.370 dm |
| Package 1 Length | 0.400 dm |

Offer Sustainability

| | |
|----------------------------|--|
| Sustainable offer status | Green Premium product |
| REACH Regulation | REACH Declaration |
| EU RoHS Directive | Pro-active compliance (Product out of EU RoHS legal scope) EU RoHS Declaration |
| Mercury free | Yes |
| RoHS exemption information | Yes |
| Environmental Disclosure | Product Environmental Profile |
| Circularity Profile | End Of Life Information |

Contractual warranty

| | |
|----------|-----------|
| Warranty | 18 months |
|----------|-----------|

Dimensions

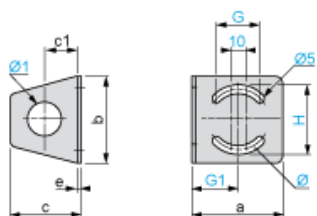

Dimensions in mm

| a | b | c | c1 | e | H | G | G1 | \varnothing | $\varnothing 1$ |
|----|----|----|----|---|----|----|----|---------------|-----------------|
| 35 | 40 | 33 | 18 | 2 | 31 | 18 | 18 | 25 | 13 |

Dimensions in in.

| a | b | c | c1 | e | H | G | G1 | \varnothing | $\varnothing 1$ |
|------|------|------|------|------|------|------|------|---------------|-----------------|
| 1.38 | 1.57 | 1.30 | 0.71 | 0.08 | 1.22 | 0.71 | 0.71 | 0.98 | 0.51 |