



Main

Range of product	Telemecanique Inductive proximity sensors XS
Accessory / separate part category	Mounting and fixing accessories
Accessory / separate part type	Fixing clamp
Accessory / separate part designation	Fixing clamp
Accessory / separate part destination	Cylindrical M12 sensor
Material	Plastic

Complementary

Product compatibility	XT cylindrical M12 XS cylindrical M12
Net weight	0.006 kg

Packing Units

Package 1 Weight	0.008 kg
Package 1 Height	0.200 dm
Package 1 width	0.450 dm
Package 1 Length	0.300 dm

Offer Sustainability

Sustainable offer status	Green Premium product
REACH Regulation	REACH Declaration
EU RoHS Directive	Pro-active compliance (Product out of EU RoHS legal scope) EU RoHS Declaration
Mercury free	Yes
RoHS exemption information	Yes
Environmental Disclosure	Product Environmental Profile
Circularity Profile	End Of Life Information

Contractual warranty

Warranty	18 months
----------	-----------

Dimensions

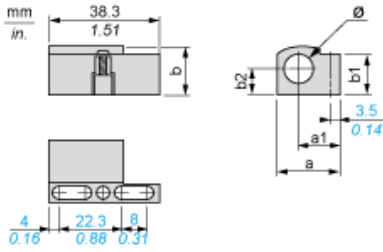

Dimensions in mm

a	a1	b	b1	b2	∅
21.9	14.5	16	15.5	8.5	12

Dimensions in in.

a	a1	b	b1	b2	∅
0.86	0.57	0.63	0.61	0.33	0.47