



Main

Range of product	Zelio Count
Product or component type	Preselection counter
Display type	Mechanical
Size	75 x 60 mm
Display digits	5 digit(s)
Counting frequency	25 Hz
Reset	Manual or electrical reset
Counting capacity	0...99999
Technology type	Electromechanical

Complementary

[Us] rated supply voltage	24 V DC Us +/- 10 %
Power consumption in W	2.5 W
Output type	Contact (volt-free)
Preset number	1
Counting mode	Adding Subtracting
Input type	Contact (20 VA/220 V/1 A maximum)
Mounting mode	Removable Flush-mounted
Mounting support	Panel mounting
Fixing mode	By screws
Connections - terminals	AMP lugs (connection box)
Height	75 mm
Number of outputs	1
Net weight	0.24 kg
Width	60 mm
Product destination	Cable
CAD overall width	60 mm
CAD overall height	75 mm
CAD overall depth	102 mm
Contacts usage	Volt-free contacts
Input current	0...1 A
Rotary handle fixing	Screws

Environment

Standards	EN 50082-2 EN 61010 EN 50081-2
Product certifications	CE
IP degree of protection	IP40 conforming to IEC 60529
Ambient air temperature for operation	-10...50 °C
Ambient air temperature for storage	-40...85 °C
Vibration resistance	5 gn (f= 10...150 Hz) conforming to IEC 60068-2-6
Shock resistance	30 gn for 6 ms conforming to IEC 60068-2-27
Electrical shock protection class	Class II conforming to IEC 60536

Packing Units

Unit Type of Package 1	PCE
Number of Units in Package 1	1
Package 1 Weight	307 g
Package 1 Height	7.8 cm
Package 1 width	12 cm
Package 1 Length	15.5 cm
Unit Type of Package 2	S02
Number of Units in Package 2	7
Package 2 Weight	2.64 kg
Package 2 Height	15 cm
Package 2 width	30 cm
Package 2 Length	40 cm

Offer Sustainability

EU RoHS Directive	Pro-active compliance (Product out of EU RoHS legal scope) EU RoHS Declaration
Mercury free	Yes
RoHS exemption information	Yes
China RoHS Regulation	China RoHS Declaration
WEEE	The product must be disposed on European Union markets following specific waste collection and never end up in rubbish bins

Contractual warranty

Warranty	18 months
----------	-----------

Electromechanical Preset Counters

Subtracting Preset Counters with Mechanical Display

XBKP50100D•0M

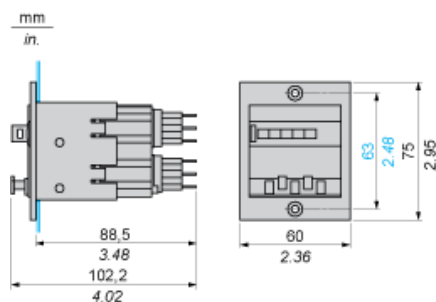

Flush-Mounting

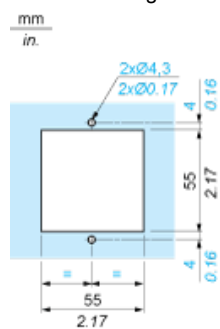

Adding Preset Counters with Mechanical Display

XBKP50100D•0M

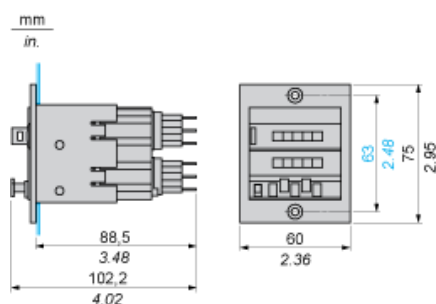

Flush-Mounting

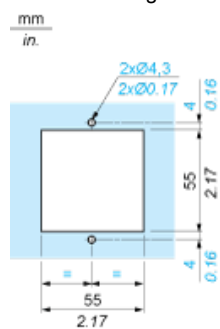

24 Vdc Supply Voltage