

K50H001YP

Cam star-delta switch, Harmony K, front mounting, plastic, 3 poles, 60°, 50A, 64x64mm front plate, 3 positions marked



Main

| | |
|--|---|
| Range of product | Harmony K |
| Product or component type | Complete cam switch |
| Component name | K50 |
| [I _{th}] conventional free air thermal current | 50 A |
| Mounting location | Front |
| Fixing mode | 4 holes |
| Cam switch head type | With front plate 64 x 64 mm |
| Type of operator | Black handle |
| Rotary handle padlocking | Without |
| Presentation of legend | With metallic legend, 0 - Y - delta black marking |
| Cam switch function | Star-delta switch |
| Return | Without |
| Off position | With Off position |
| Poles description | 3P |
| Switching positions | Right: 0° - 60° Left: 0° - 300° |
| IP degree of protection | IP40 conforming to IEC 60529 |

Complementary

| | |
|---|--|
| Switching angle | 60 ° |
| [U _i] rated insulation voltage | 690 V (pollution degree 3) conforming to IEC 60947-1 |
| Short-circuit current | 5000 A |
| Short-circuit protection | 63 A cartridge fuse, type gG |
| [U _{imp}] rated impulse withstand voltage | 6 kV conforming to EN 947-1 6 kV conforming to IEC 947-1 |
| Contact operation | Slow-break |
| Positive opening | With |
| Electrical connection | Captive screw clamp terminals flexible, clamping capacity: 2 x 6 mm ² Captive screw clamp terminals solid, clamping capacity: 2 x 10 mm ² |
| Tightening torque | 2 N.m |

| | |
|--------------------------|---|
| Switching capacity in mA | 15000 mA DC at 120 V 2 contact(s) for inductive load (T = 50 ms) 15000 mA DC at 180 V 3 contact(s) for inductive load (T = 50 ms) 15000 mA DC at 60 V 1 contact(s) for inductive load (T = 50 ms) 20000 mA DC at 140 V 3 contact(s) for inductive load (T = 50 ms) 20000 mA DC at 48 V 1 contact(s) for inductive load (T = 50 ms) 20000 mA DC at 95 V 2 contact(s) for inductive load (T = 50 ms) 30000 mA DC at 30 V 1 contact(s) for inductive load (T = 50 ms) 30000 mA DC at 60 V 2 contact(s) for inductive load (T = 50 ms) 30000 mA DC at 90 V 3 contact(s) for inductive load (T = 50 ms) 3500 mA DC at 110 V 1 contact(s) for inductive load (T = 50 ms) 3500 mA DC at 220 V 2 contact(s) for inductive load (T = 50 ms) 3500 mA DC at 330 V 3 contact(s) for inductive load (T = 50 ms) 37000 mA DC at 120 V 2 contact(s) for resistive load (T = 1 ms) 37000 mA DC at 180 V 3 contact(s) for resistive load (T = 1 ms) 37000 mA DC at 60 V 1 contact(s) for resistive load (T = 1 ms) 40000 mA DC at 140 V 3 contact(s) for resistive load (T = 1 ms) 40000 mA DC at 24 V 1 contact(s) for inductive load (T = 50 ms) 40000 mA DC at 48 V 1 contact(s) for resistive load (T = 1 ms) 40000 mA DC at 48 V 2 contact(s) for inductive load (T = 50 ms) 40000 mA DC at 70 V 3 contact(s) for inductive load (T = 50 ms) 40000 mA DC at 95 V 2 contact(s) for resistive load (T = 1 ms) 50000 mA DC at 24 V 1 contact(s) for resistive load (T = 1 ms) 50000 mA DC at 48 V 2 contact(s) for resistive load (T = 1 ms) 50000 mA DC at 70 V 3 contact(s) for resistive load (T = 1 ms) |
| Mechanical durability | 300000 cycles |
| CAD overall width | 64 mm |
| CAD overall height | 64 mm |
| CAD overall depth | 138 mm |
| Net weight | 0.61 kg |



Environment

| | |
|---------------------------------------|---|
| Standards | IEC 60947-3 |
| Product certifications | CULus 120 V 3 hp 1 phase CULus 480 V 25 hp 3 phases CULus 240 V 7.5 hp 1 phase CULus 240 V 7.5 hp 3 phases |
| Protective treatment | TC |
| Ambient air temperature for operation | -25...55 °C |
| Ambient air temperature for storage | -40...70 °C |
| Overvoltage category | Class II conforming to IEC 60536 Class II conforming to NF C 20-030 |

Packing Units

| | |
|------------------------------|----------|
| Unit Type of Package 1 | PCE |
| Number of Units in Package 1 | 1 |
| Package 1 Height | 7.2 cm |
| Package 1 Width | 7.2 cm |
| Package 1 Length | 15.5 cm |
| Package 1 Weight | 465.0 g |
| Unit Type of Package 2 | S03 |
| Number of Units in Package 2 | 20 |
| Package 2 Height | 30.0 cm |
| Package 2 Width | 30.0 cm |
| Package 2 Length | 40.0 cm |
| Package 2 Weight | 9.812 kg |

Offer Sustainability

| | |
|------------------------|--|
| REACH Regulation |  REACH Declaration |
| REACH free of SVHC | Yes |
| EU RoHS Directive | Pro-active compliance (Product out of EU RoHS legal scope)  EU RoHS Declaration |
| Toxic heavy metal free | Yes |
| Mercury free | Yes |

| | |
|----------------------------|---|
| China RoHS Regulation |  China RoHS Declaration |
| RoHS exemption information |  Yes |
| WEEE | The product must be disposed on European Union markets following specific waste collection and never end up in rubbish bins |

Contractual warranty

| | |
|----------|-----------|
| Warranty | 18 months |
|----------|-----------|

Dimensions

Front Mounting

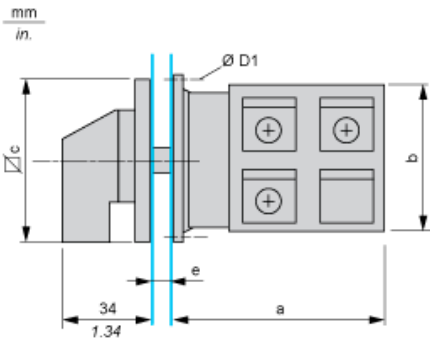

e support panel thickness 0.5 to 5.5 mm / 0.02 to 0.22 in in.

| a | | b | | c | | D1 | |
|------|------|----|------|----|------|-----|------|
| mm | in. | mm | in. | mm | in. | mm | in. |
| 98.3 | 3.87 | 60 | 2.36 | 64 | 2.52 | 4.1 | 0.16 |

Panel Cut-Out

Front Mounting

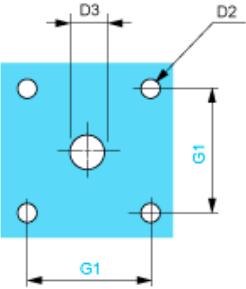

| D2 | | D3 | | G1 | |
|-----|------|----|------|----|------|
| mm | in. | mm | in. | mm | in. |
| 4.5 | 0.18 | 10 | 0.39 | 48 | 1.89 |

Link Positions (Factory Mounted)

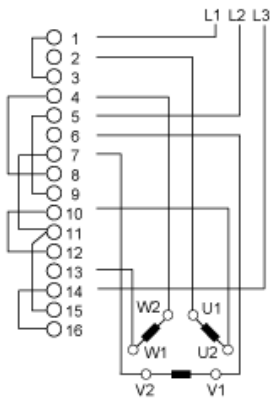

Marking

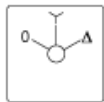

Angular Position of Switch



Switching Program

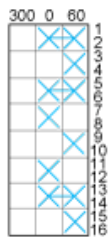

Convention Used for Switching Program Representation

- Contact closed
- Contact closed in 2 positions and maintained between the 2 positions
- Sealed assembly for auto-maintain control
- Overlapping contacts
- Spring return position: for a switching angle of 90°, spring return is over 30° after the last position (for a maximum of 3 simultaneous contacts).

Example:

